

# V-FORCE 2 CART

NUMERIC UNDERPINNER

Designed for

**Bespoke**  
Framer

**Retail**  
Framer

**Medium**  
Contract Framer

**Volume**  
Contract Framer

The V-FORCE 2 CART works with **Cassese cartridge wedges**

Speed



Moulding capacity



Ease of use



Space required



## THE V-FORCE 2 CART FROM CASSESE

is a numeric underpinner (v-nailer) with high speed joining capacity.

The V-FORCE 2 CART is easy to use thanks to its user-friendly touchscreen and its quick and easy joining set up.

The V-FORCE 2 CART can join high and wide mouldings while ensuring a perfect joining quality thanks to the retractable tightening clamps system.

To improve your production time, you can register up to 3 000 favorites moulding profiles with iconic identification.

The V-FORCE 2 CART uses Cassese cartridge wedges, recognized today as the best on the market and allowing you to load the machine faster.

### DIMENSIONS

Length	650 mm
Width	600 mm
Height	1150 mm

### MOULDING CAPACITY (mm)

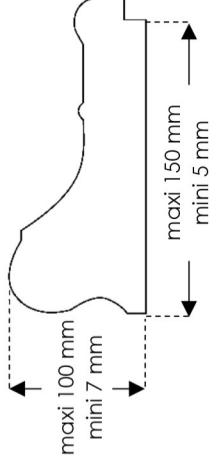

### AIR SUPPLY

6 bars
1 L / wedge

### WEIGHT

103 kg

## NEW OPTIONNAL ACCESSORY The S.M.C. System (Smart Moulding Configuration)



Thanks to a cutting-edge laser, you can scan your moulding and the machine will suggest you the best positions, numbers and size of wedges needed.



MADE IN  
FRANCE



Electric supply

110 / 230V single phase  
50 / 60 Hz  
0,5KW



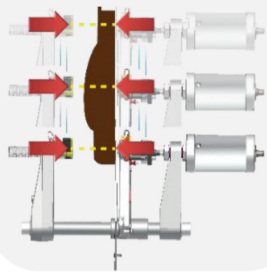

### The Smart Wedge Drive System™

#### Auto-alignment

No need to adjust top clamp placement

#### Self-adjusting pressure

No need to adjust air pressure between Hardwood and Softwood

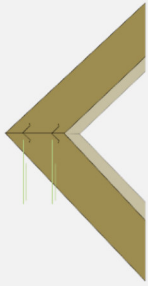
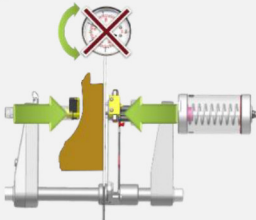

**High speed joining = 3360 cycles / hour**  
(with 2 positions per corner)

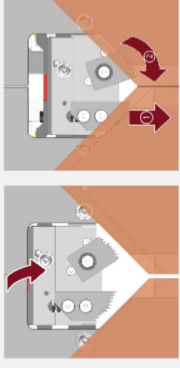

Retractable and very powerful Ultra™ clamps (patented)

### NEW INTERFACE AND CUTTING-EDGE ELECTRONICS (DRIVER, SCREEN, PROGRAM CONTROLLER)

User-friendly touchscreen and easy to use menus



Quick and Easy joining set up with iconic identification



Complete tutorial to guide you step by step



**3 000 Favorites Profiles**  
(Import your MACH profiles)

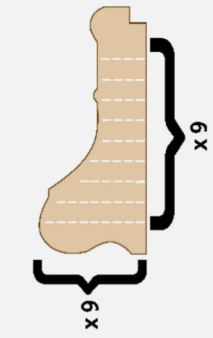

9 wedge positions  
9 wedges per position

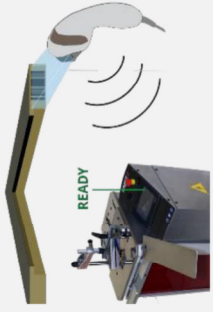

Barcode Ready  
(compatible with MACH, CS486, CS3099 & CS4008 joining files)

### CASSESE CARTRIDGES ARE...



Even stronger (thanks to Power Strip™)



Lubricated = easy stacking



Color coded easy size identification



**100% wedges used**



Glue free = No jammings  
Economical  
Eco-Friendly (Recyclable Plastic)



Z3078



Z26999



Z21525



Z21524



Z18065



Z1783



Z1791



Z21525

1 box of 7mm SW  
1 box of 10 mm SW  
1 box of 10mm HW



Z21476



Z25790



Z1814



Z1813



Z29729

**The S.M.C System**  
(Smart Moulding Configuration)



Concrete reinforced structure to absorb vibrations

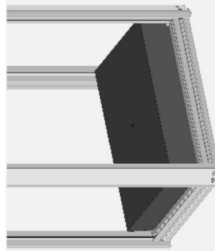

Adjustable rod clamp

Magnetic chevron clamp

Solid crossbar

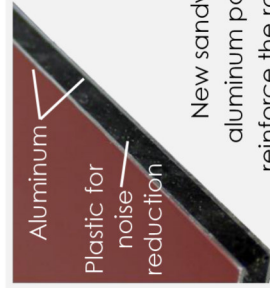

New sandwich aluminum panel to reinforce the robustness

Aluminum  
Plastic for noise reduction

### INCLUDED ACCESSORIES

### OPTIONAL ACCESSORIES